

Capital

SINCE 1936

2850 SERIES COMMERCIAL & INDUSTRIAL WATER CONDITIONERS

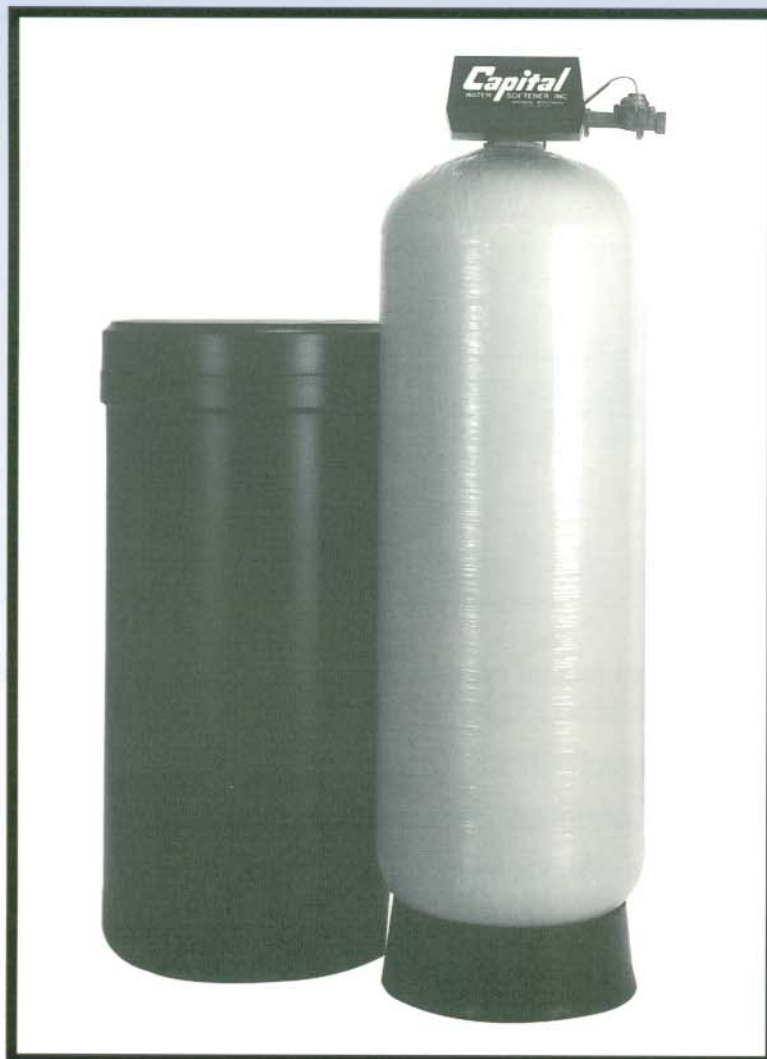

APARTMENT BUILDINGS
BOILER TREATMENT
CAR WASHES
COMMERCIAL BUILDINGS
CONDOMINIUMS
FACTORIES
HEALTH CLUBS

HOSPITALS
LAUNDRIES
MOTELS AND HOTELS
NURSING AND REST HOMES
OFFICE BUILDINGS
RESTAURANTS
SCHOOLS

"You never had it so soft!"

Capital Means Excellence

One of the original pioneers in water conditioning, Capital Water Softener, Inc. has been building quality products since 1936. Quality built in to allow quality to come out. As our motto goes, "You never had it so soft!" Only the best are allowed to display the Capital name.

2850 Series Conditioners are the ultimate choice for the mid-size jobs. More flow rate than domestic water conditioners and less than the unneeded more expensive larger systems. Has automatic hard water by-pass during regeneration for single or twin systems or capabilities for no hard water by-pass with the aid of diaphragm valves (shut-offs on the outlet side) for twin, twin alternating, or multiple systems. No time consuming wiring is necessary. Completely factory wired for fast and easy installations. The regeneration of the **TI Series** water conditioners are timer initiated with either a 7 or 12 day timer. The regeneration of the **MI-Series** water conditioners are initiated by a mechanical demand metering system and the **ET-Series** water conditioners are initiated by a microprocessor demand metering system. All systems are capable of immediate, delayed, or manual regenerations.

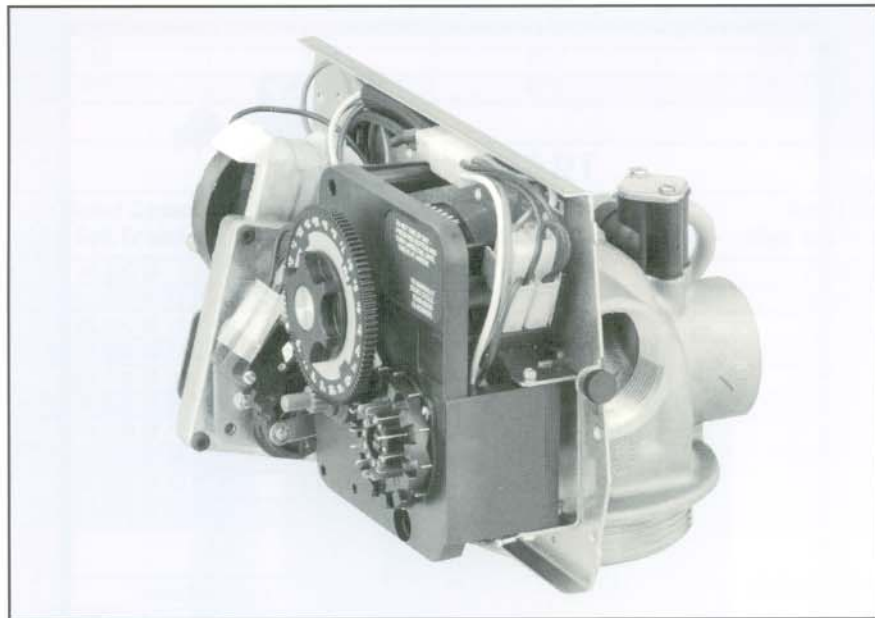

- The 2850 Series valve is a top mount control valve with a 1.5" NPT inlet and outlet, perfect for small to medium sized jobs.
- Solid brass lead free control valve body for strength and durability.
- Fully adjustable five cycle control delivers controlled upflow backwash with downflow brining, slow rinse, rapid rinse, and service.
- Time tested hydraulically balanced piston, seal, and spacer concept to pilot water flow during service and regeneration completely independent of water pressure.
- Factory installed flow controls for accurate and efficient salt dosage with each regeneration
- Timed brine refill is fully adjustable to accommodate any desired salt dosage.

2850 WATER CONDITIONERS

- A. MINERAL TANK:** Fiberglass Reinforced Pressure Vessel manufactured to operate at 150 PSI and 120°F. NSF approved.
- B. DISTRIBUTOR SYSTEM:** Bottom Stack — Slotted Distributor, or Hub Lateral System. For maximum service flow and minimal pressure drop.
- C. UNDERBEDDING:** Gravel Underbedding allows full usage of the mineral bed and uniform distribution of flow for service and regeneration. UL listed, NSF approved.
- D. MINERAL:** High Capacity Ion Exchange, FDA approved, U.S. manufactured. Uniform beads for maximum hardness removal and long life.
- E. BRINE TANK:** FDA approved High Density Polyethylene Brine Tank with environmental stress crack properties and dust resistant cover.
- F. SALT GRID:** Salt Grid Systems minimizes the salt from bridging and improves the brine concentration to obtain full capacity with each and every regeneration.
- G. FLOAT VALVE:** Works as a secondary safety shut-off for the brine valve in the main control valve as well as a salt dosage control.

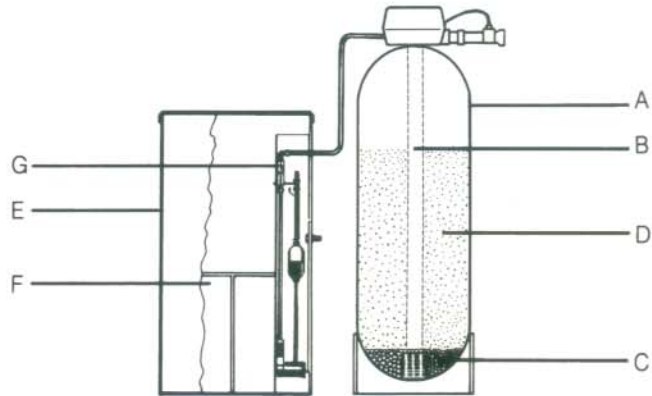

Single System Piping Diagram

1" METER SPECIFICATIONS

- Standard Range 310 Gal. Min. to 5,270 Gal. Max.
- Flow Accuracy $\pm 5\%$ 0.7 to 40 gpm.
- Extended Range 1,550 Gal. Min. to 26,350 Gal. Max.

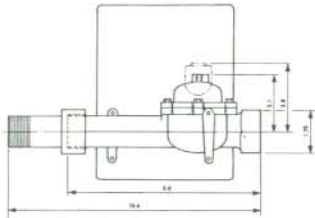

1.5" METER SPECIFICATIONS

- Standard Range 625 Gal. Min. to 10,625 Gal. Max.
- Extended Range 3,125 Gal. Min. to 53,125 Gal. Max.
- Flow Accuracy $\pm 5\%$ 1.5 to 75 gpm.

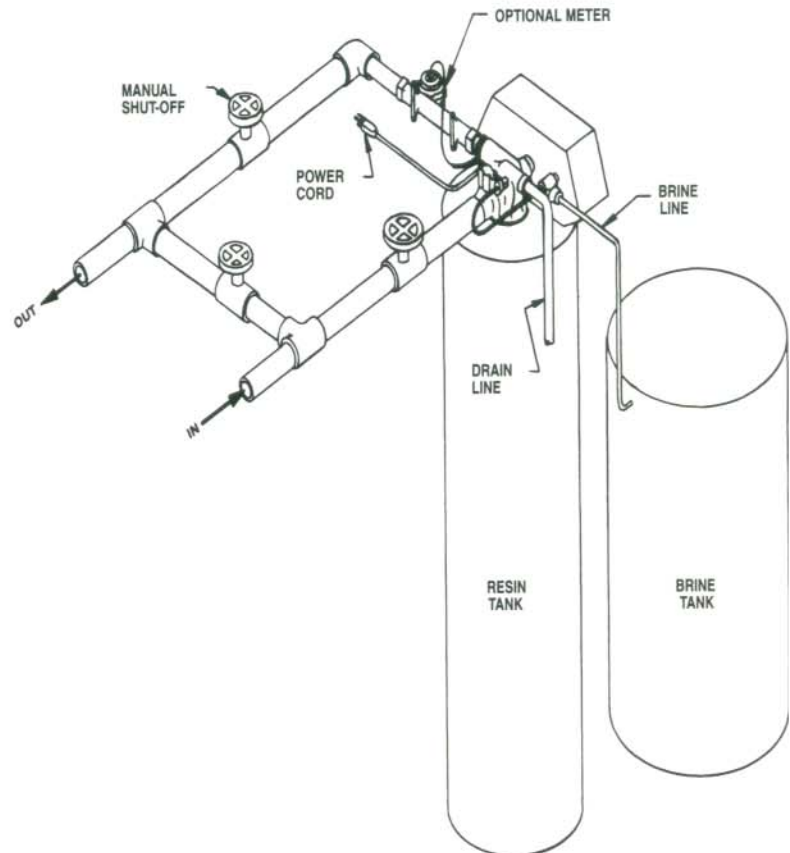
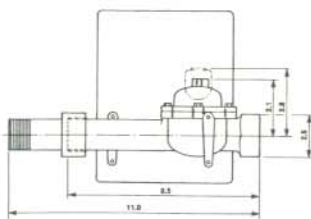

SPECIFICATIONS

2850 TI, MI, ET Series	Mineral Tank Inches	Brine Tank Inches	Salt Storage Lbs.	Shipping Weight Lbs.	2850 Pipe Size
48-1.5"	10 x 54	18 x 33	170	200	1.5"
64-1.5"	13 x 54	18 x 40	300	265	1.5"
96-1.5"	14 x 65	24 x 41	525	320	1.5"
128-1.5"	16 x 65	24 x 41	525	425	1.5"
160-1.5"	21 x 62	24 x 50	510	555	1.5"
192-1.5"	21 x 62	24 x 50	510	610	1.5"
224-1.5"	21 x 62	24 x 50	510	665	1.5"
256-1.5"	24 x 72	30 x 48	700	750	1.5"
288-1.5"	24 x 72	30 x 48	700	805	1.5"
320-1.5"	24 x 72	30 x 48	700	855	1.5"

SPECIFICATIONS

2850 TI, MI, ET Series	Gravel Lbs.	Resin Cu. Ft.	Flow Rate Cont. 15 PSI Drop	Flow Rate Cont. 25 PSI Drop	BKW GPM
48-1.5"	15	1.50	22.0	31.0	2.4
64-1.5"	35	2.00	31.0	43.0	3.0
96-1.5"	39	3.00	30.0	42.0	5.0
128-1.5"	50	4.00	33.0	45.0	7.0
160-1.5"	80	5.00	42.0	55.0	10.0
192-1.5"	80	6.00	40.0	54.0	10.0
224-1.5"	80	7.00	39.0	52.0	10.0
256-1.5"	100	8.00	42.0	56.0	15.0
288-1.5"	100	9.00	41.0	55.0	15.0
320-1.5"	100	10.00	40.0	54.0	15.0

CAPACITY CHART

2850 TI, MI, ET Series	Rated Capacity Low Salt Grains @ Lbs	Rated Capacity Medium Salt Grains @ Lbs	Rated Capacity High Salt Grains @ Lbs
48-1.5"	30,000 @ 9.0	36,000 @ 12.0	48,000 @ 22.5
64-1.5"	40,000 @ 12.0	48,000 @ 16.0	64,000 @ 30.0
96-1.5"	60,000 @ 18.0	72,000 @ 24.0	96,000 @ 45.0
128-1.5"	80,000 @ 24.0	96,000 @ 32.0	128,000 @ 60.0
160-1.5"	100,000 @ 30.0	120,000 @ 40.0	160,500 @ 75.0
192-1.5"	130,000 @ 38.0	150,000 @ 50.0	192,000 @ 90.0
224-1.5"	140,000 @ 42.0	168,000 @ 56.0	224,000 @ 105.0
256-1.5"	160,000 @ 48.0	192,000 @ 64.0	256,000 @ 120.0
288-1.5"	180,000 @ 54.0	216,000 @ 72.0	288,000 @ 135.0
320-1.5"	200,000 @ 60.0	240,000 @ 80.0	320,000 @ 150.0

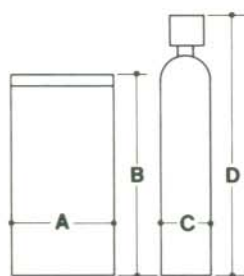

DIMENSIONS				
MODEL	A	B	C	D
48	18	33	10	60.50
64	18	40	13	60.50
96	24	41	14	71.50
128	24	41	16	71.50
160	24	50	21	73.50
192	24	50	21	73.50
224	24	50	21	73.50
256	30	48	24	80.50
288	30	48	24	80.50
320	30	48	24	80.50

Form No. 2850 TI-MI-ET Series

OPERATING CONDITIONS

1. Temperature not to exceed 110°F and not to drop below 34°F.
2. Water pressure, minimum 25 PSI and maximum 120 PSI.
3. Equipment subject to change without notice due to continuous product development.

WARRANTY

- 3 YEARS — ALL PARTS
- 5 YEARS — MINERAL TANK
- 5 YEARS — BRINE TANK

DEALER

Capital
"SINCE 1936"

Water Quality
ASSOCIATION
MEMBER

MANUFACTURED BY:
CAPITAL WATER SOFTENER, INC.
2096 HELENA ST.
MADISON, WI 53704

608-241-1511